

DRAFT

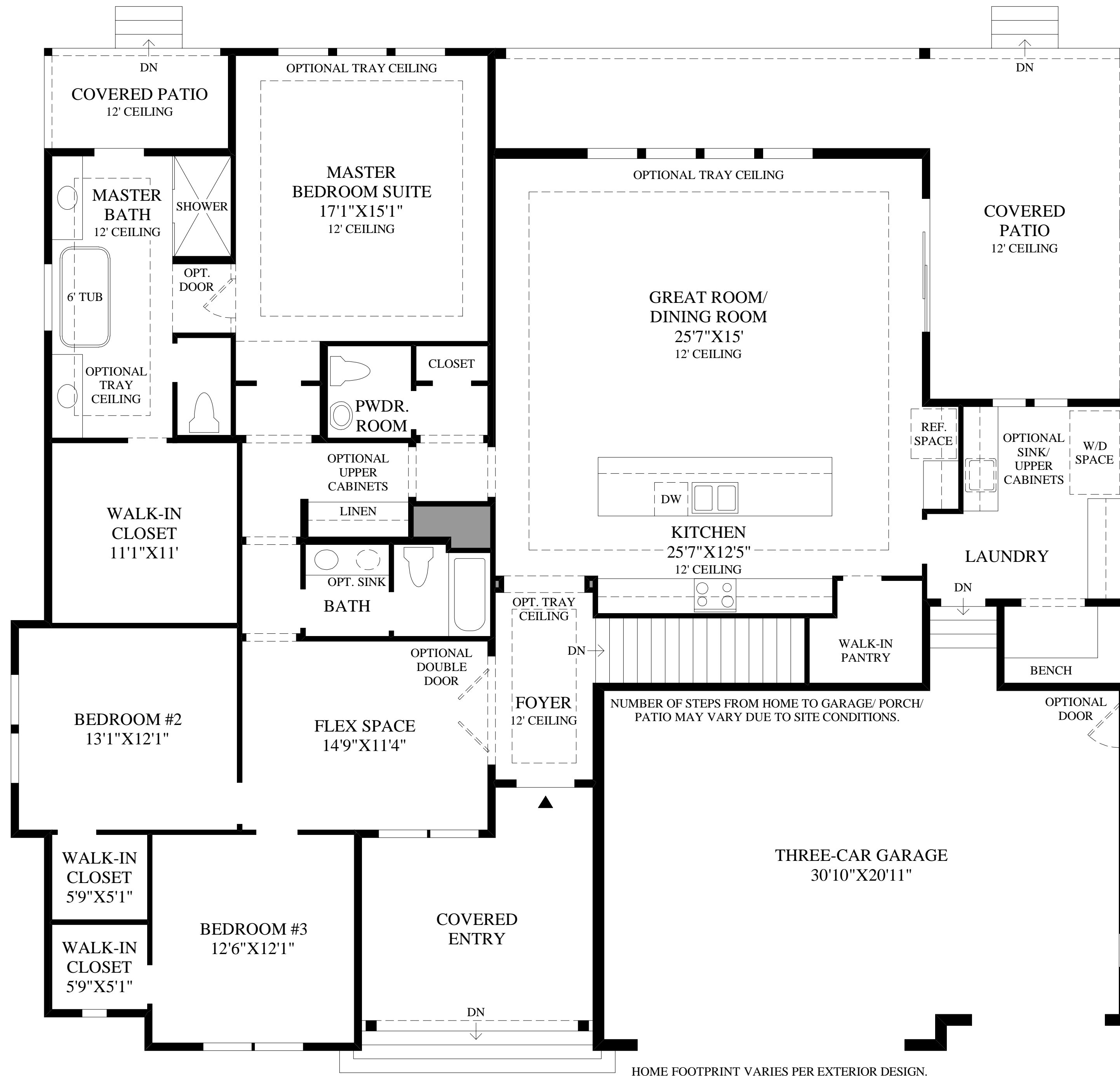

THE EVANS HIGHLIGHTS

- A generous covered entry welcomes you upon arrival to this wonderful open-concept home, which boasts 10' ceilings throughout.
- Elevated ceiling heights in the main living areas in conjunction with a radiant window display help to create the visually stunning main living areas.
- This stylish kitchen offers an elongated center island that incorporates a breakfast bar for informal dining, a walk-in pantry, and ample counter space.
- Completing the master bedroom suite is an elevated ceiling height, a private covered patio, a large walk-in closet, and a spa-like master bath.
- Additional highlights include a versatile flex space, a convenient powder room, an accommodating laundry room with a built-in bench, and an expansive rear covered patio that wraps around the rear of the home.

Floor Plan

FARMHOUSE EXTERIOR DESIGN SHOWN

DRAFT