

Powderhorn

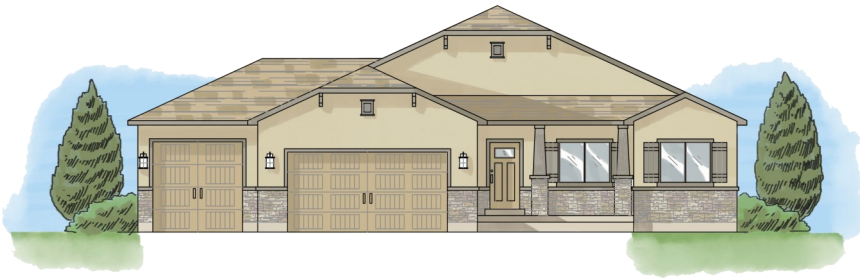

Bungalow Elevation

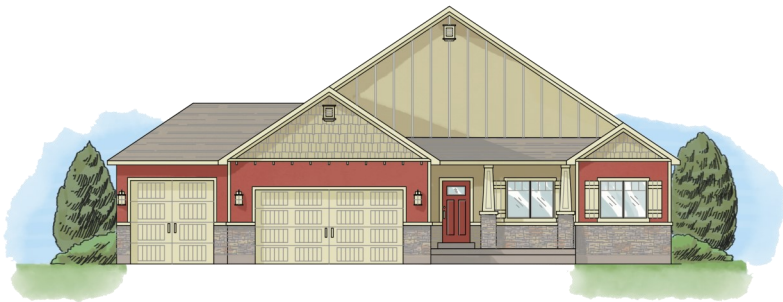

Craftsman Elevation

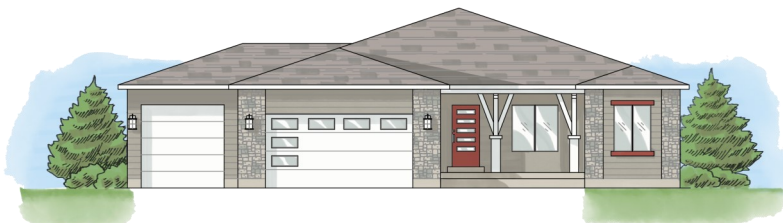

Nouveau Elevation

| | |
|------------|-------------------------------|
| Main Floor | 1473 sf |
| Basement | 1500 sf |
| Upstairs | Optional Bonus |
| Total SF | 2973 sf |
| Garage | 2 or 3 car front or side load |

The Powderhorn is a 3 bedroom home designed to expand with an optional basement. Efficient living with plenty of space. Infinity option is available.

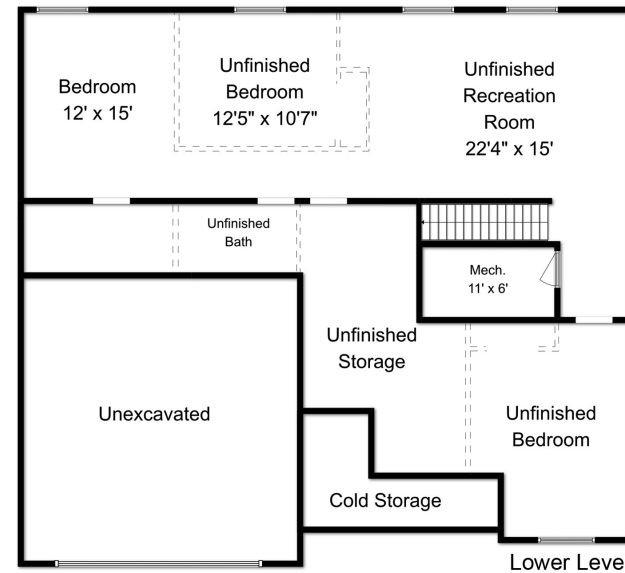
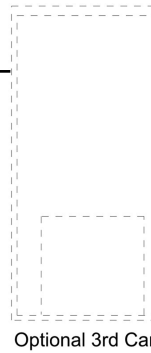

Notes

