

# SUNSET EQUESTRIAN

Kaysville

Phase 18

\*All renderings are artists' conception. Continuing a policy of constant design and pricing improvement, we reserve the right of price, product or design change without obligation to notify.

SOLD

AVAILABLE

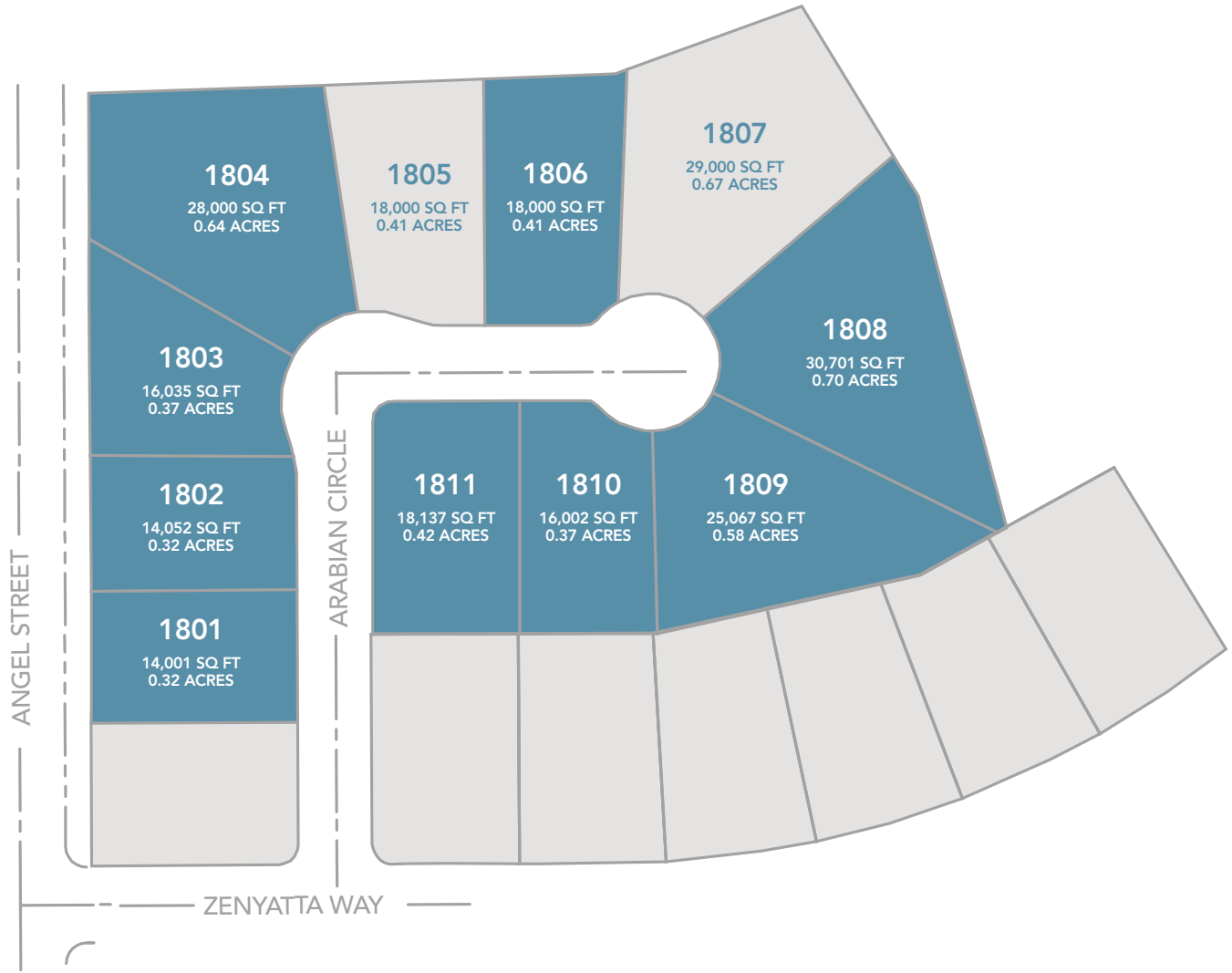

## Symphony Homes

[symphonyhomes.com](http://symphonyhomes.com)

801.298.8555

# SUNSET EQUESTRIAN

Kaysville

Phase 15

\*All renderings are artists' conception. Continuing a policy of constant design and pricing improvement, we reserve the right of price, product or design change without obligation to notify.



**Symphony Homes**

[symphonyhomes.com](http://symphonyhomes.com)

801.298.8555